

M

Solid Carbide Miniature Thread Mill for Hard Materials, ISO Metric Internal Thread – DIN13

- ◆ Material : Solid Carbide
- ◆ Shank : DIN6535 HA
- ◆ Left Hand Cut, Straight Flute
- ◆ Thread Length : 2 x P
- ◆ For Hard Materials Up to 62HRc
- ◆ AlTiN Coated
- ▶ Left hand Cut (CNC code : M04).
- ▶ The work direction is from top to bottom (Climb Milling).

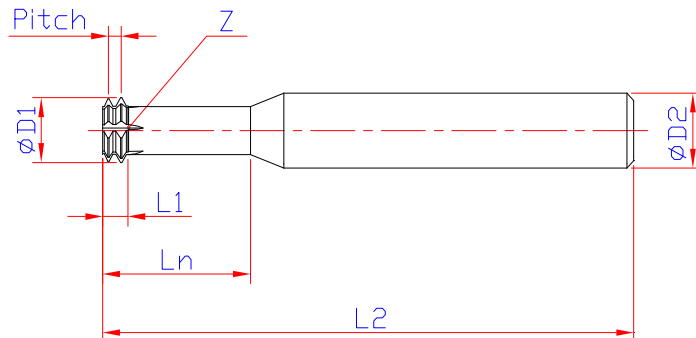

* Unit : mm

Nominal Dia.	Pitch / TPI	Cutter Dia.	Shank Dia.	Thread Length	Neck Length	Over all Length	No. of Flute	EDP No.
[D]	Pitch	ØD1	ØD2	L1	Ln	L2	Z	
M2	0.4	1.52	6	0.8	4.2	57	4	L19E1130
M2.2	0.45	1.66	6	0.9	4.6	57	4	L19E1150
M2.5	0.45	1.96	6	0.9	5.3	57	4	L19E1170
M3	0.5	2.4	6	1.0	6.3	57	4	L19E1200
M4	0.7	3.16	6	1.4	8.4	57	4	L19E1240
M5	0.8	4.04	6	1.6	10.5	57	4	L19E1280
M6	1.0	4.8	6	2.0	12.6	57	5	L19E1310
M8	1.25	6.5	8	2.5	16.8	63	5	L19E1360
M10	1.5	8.2	10	3.0	21.0	73	6	L19E1420
M12	1.75	9.9	10	3.5	25.2	73	6	L19E1500